

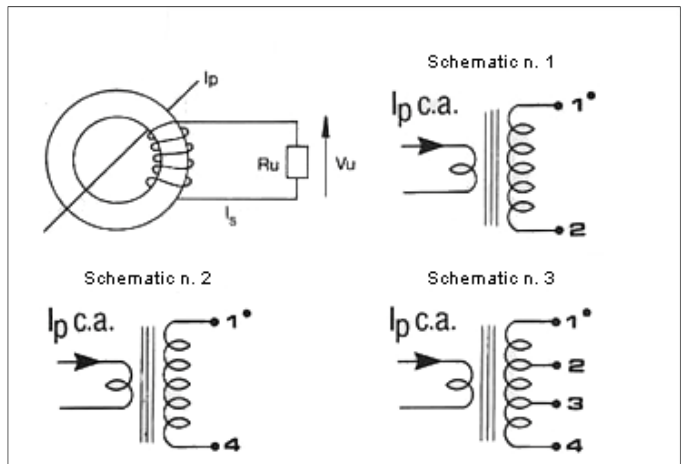

TA - Current Transformers 25-600A

Italtras



Dimensioni fisiche in mm Physical dimension in mm

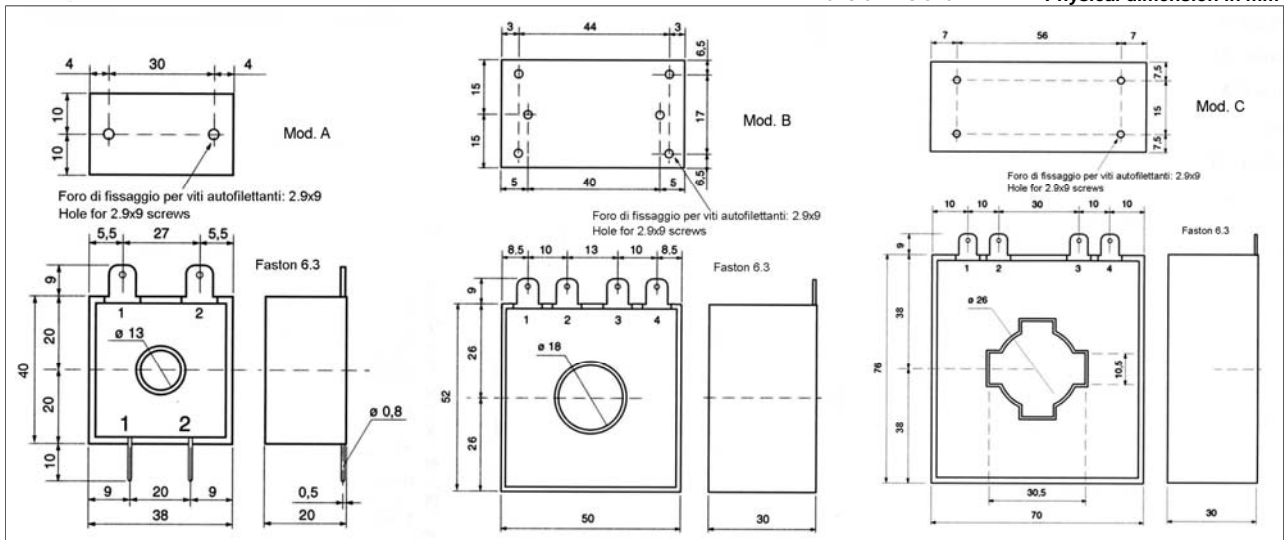

Trasformatori Amperometrici TA - Current Transformers									
Code	Model	Ip/Is Amp	Ratio	Schematic	Outputs	Ru Ohm	Vu Vac	Accuracy %	Weight Gr
42360000	A	25/0.05	n(1-2): 500	1	1-2	40	2	2.0%	90
42360100	A	50/0.05	n(1-2): 1000	1	1-2	80	4	1.0%	90
42360200	B	100/0.2	n(1-4): 500	2	1-4	20	4	0.8%	176
42360300	B	25/0.2	n(1-2): 125	3	1-2	20	4	2.5%	350
		50/0.22	n(1-3): 250		1-3	20	4	1.5%	
42360400	B	100/0.1	n(1-4): 1000	2	1-4	20	2	0.4%	180
		200/0.2	n(1-4): 1000		1-4	20	4	0.8%	
42360500	B	200/0.2	n(1-4): 1000	2	1-4	10	2	0.4%	180
42360600	C	400/0.4	n(1-4): 1000	2	1-4	20	8	0.4%	180
		200/0.4	n(1-2): 500		1-2	20	8	1.0%	
42360700	C	400/0.4	n(1-3): 1000	3	1-3	20	8	0.4%	350
		600/0.4	n(1-4): 1500		1-4	20	8	0.2%	
42360800	C	400/0.2	n(1-4): 2000	2	1-4	20	4	0.2%	185
		200/0.2	n(1-2): 1000		1-2	20	4	0.5%	
42360900	C	300/0.2	n(1-3): 1500	3	1-3	20	4	0.3%	350
		400/0.2	n(1-4): 2000		1-4	20	4	0.2%	
42361000	C	600/0.6	n(1-4): 1000	2	1-4	10	6	0.2%	340
42361100	C	600/0.2	n(1-4): 3000	2	1-4	20	4	0.5%	340

Dati tecnici	Technical data
Conformità alle norme CEI EN 60044-1 - RoHS	CEI EN 60044-1 approved - RoHS
Certificazione CE	CE certification
Tensione di isolamento 3750 VAC	Insulation voltage 3750 VAC
Frequenza nominale 50/60 Hz	Nominal frequency 50/60 Hz
Temperatura ambiente 40 °C	Ambient temperature 40 °C
Sistema di isolamento classe B (F su richiesta)	Class B insulation system (F on request)
Grado di protezione IP00	Degree of protection IP00
Avvolgimenti in rame smaltato classe H	Class H enamelled copper wire coils
Test elettrici sul 100% della produzione	100% tested production
Lamierino a grani orientati	Grain oriented laminated

Iso 9001 Certified

